

**CERTIFICATION & ALTERATION NOTE:**

UNAUTHORIZED ALTERATION OR ADDITION TO A SURVEY MAP BEARING A LICENSED LAND SURVEYOR'S SEAL IS A VIOLATION OF SECTION 7209, SUB-DIVISION 2, OF THE NEW YORK STATE EDUCATION LAW. ONLY COPIES FROM THE ORIGINAL OF THIS SURVEY MARKED WITH AN ORIGINAL OF THE LAND SURVEYOR'S INKED SEAL OR EMBOSSED SEAL SHALL BE CONSIDERED TO BE VALID TRUE COPIES. CERTIFICATIONS INDICATED HEREON SIGNIFY THAT THIS SURVEY WAS PREPARED IN ACCORDANCE WITH THE EXISTING CODE OF PRACTICE FOR LAND SURVEYS ADOPTED BY THE NEW YORK STATE ASSOCIATION OF PROFESSIONAL LAND SURVEYORS. SAID CERTIFICATIONS SHALL RUN ONLY TO THE PERSON FOR WHOM THE SURVEY IS PREPARED, AND ON THEIR BEHALF TO THE TITLE COMPANY, LENDING INSTITUTION AND/OR GOVERNMENTAL AGENCY LISTED HEREON, AND THE SUCCESSORS AND/OR ASSIGNEES OF THE LENDING INSTITUTION. CERTIFICATIONS ARE NOT TRANSFERABLE TO ADDITIONAL INSTITUTIONS OR SUBSEQUENT OWNERS. LOCATIONS OF UNDERGROUND IMPROVEMENTS OR ENCROACHMENTS, IF ANY EXIST EXCEPT AS SHOWN HEREON, ARE NOT KNOWN AND ARE NOT COVERED BY THIS CERTIFICATION.

COPYRIGHT 2008 F. MICHAEL HEMMER, LS, P.C. ALL RIGHTS RESERVED

File Map North  
 TOTAL LOT AREA  
 111,536± SQ.FT.  
 or 2.560± ACRES

TABLE OF AREAS	(SQ. FT.)
LOT AREA	111,536
TOTAL ROOFED COVERAGE	10,086
ALLOWED ROOFED COVERAGE	11,154
(111,536 * 0.10)	

LOT 6  
 N/F  
 KAREN KALIMIAN

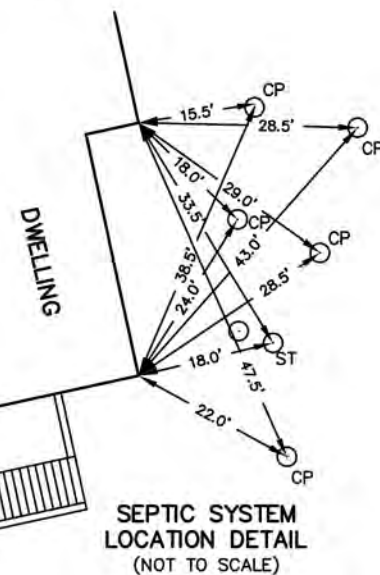

LOT 8  
 N/F  
 HENRY OSTBERG

**CERTIFIED TO:**  
 ETAI SOUTH BEACH  
 INVESTORS, LLC